



Knights Road,  
Mansfield, NG19 6FR



**Knights Road,  
Mansfield, NG19 6FR  
£319,950 Freehold**

**\*\* 4 BED DETACHED HOME, PRESENTED TO A SHOW HOME STANDARD ON A MODERN DEVELOPMENT \*\***

This property is immaculately presented and is situated on a well sought after development. Briefly comprising of the following: L-shaped entrance hallway, lounge to the front elevation, dining room/second reception room to the front elevation, open-plan kitchen/diner with modern quartz countertops. The utility room is situated off the kitchen with back door access onto the rear garden along with a downstairs cloakroom/WC.

First floor: Galleried landing with loft access, four double bedrooms, En-suite shower room off of the main bedroom, with a rain shower, and a beautiful family bathroom to relax and unwind in.

Externally: Situated at the end of a private road is a tarmac driveway for two cars, a laid-to lawn front garden, detached double garage (with power and lighting), and gated side access. Also with an enclosed rear garden to the rear elevation, which is mainly laid-to lawn and paved patio area.

**STILL UNDER NHBC BUILDERS WARRANTY!!!**



#### Hall

Entrance door, stairs leading to the first floor and a radiator.

#### Kitchen/Diner | 20' 03" x 9' 06"

Double glazed window to the rear, double glazed French doors to the rear, high gloss wall and base units with Quartz work surface over, inset sink with mixer tap, integrated double oven with four ring induction hob over, fridge, freezer, dishwasher, spot lights to the ceiling and a radiator.

#### Lounge | 13' 03" x 10' 09"

Double glazed window to the front and a radiator.

#### Dining Room | 10' 10" x 9' 10"

Double glazed window to the front and a radiator.

#### Utility Room | 5' 02" x 6' 02"

Door to the rear, wall and base units with roll edge work surface over, plumbing and a radiator.

#### W.C.

Double glazed window to the side, W.C., wash hand basin with mixer tap, tiled splash backs and a radiator.

#### Landing

Double glazed window to the side, storage cupboard and loft access.

#### Bedroom One | 11' 05" x 10' 11"

Double glazed window to the rear and a radiator.

#### Bedroom Two | 11' 06" x 8' 04"

Double glazed window to the front and a radiator.

#### Bedroom Three | 9' 10" x 9' 02"

Double glazed window to the front and a radiator.

#### Bedroom Four | 8' 02" x 7' 09"

Double glazed window to the front and a radiator.

#### Bathroom

Double glazed window to the rear, bath with mixer tap and shower head, W.C., wash hand basin with mixer tap, tiled splash backs and a radiator.

#### En-suite

Double glazed window to the rear, shower, W.C., wash hand basin with mixer tap, tiled splash backs and a radiator.

#### Detached Double Garage | 17' 10" x 17' 05"

Two up and over doors with power and lighting.



- **\*\*6 YEARS NHBC WARRANTY REMAINING\*\***
- **GCH system -combination boiler under warranty**
- **En-suite has the benefit of a rain shower**
- **Thousands spent on upgrades such as Quartz worktops in the kitchen, double oven and integrated fridge/freezer and dishwasher.**



Energy Efficiency Rating		
	Current	Potential
Very energy efficient - lower running costs		
(92 plus) <b>A</b>		
(81-91) <b>B</b>		
(69-80) <b>C</b>		
(55-68) <b>D</b>		
(39-54) <b>E</b>		
(21-38) <b>F</b>		
(1-20) <b>G</b>		
Not energy efficient - higher running costs		
<b>England &amp; Wales</b>	EU Directive 2002/91/EC	

**COUNCIL TAX INFORMATION:**

Local Authority: Mansfield District Council  
Council Tax Band: D

**AGENTS NOTE – DRAFT PARTICULARS:**

These particulars are issued in good faith but do not constitute representations of fact or form part of any offer or contract. The matters referred to in these particulars should be independently verified by prospective buyers or tenants. Neither Newton Fallowell nor any of its employees or agents has any authority to make or give any representation or warranty whatever in relation to this property.

Anti-Money Laundering Regulations: Intending purchasers will be asked to produce identification documentation at the offer stage and we would ask for your co-operation in order that there will be no delay in agreeing the sale.

Newton Fallowell and our partners provide a range of services to buyers, although you are free to use an alternative provider. For more information simply speak to someone in our branch today. We can refer you on to The Mortgage Advice Bureau for help with finance. We may receive a fee of £200, if you take out a mortgage through them. If you require a solicitor to handle your purchase we can refer you on to our in house solicitors. We may receive a fee of £300 if you use their services

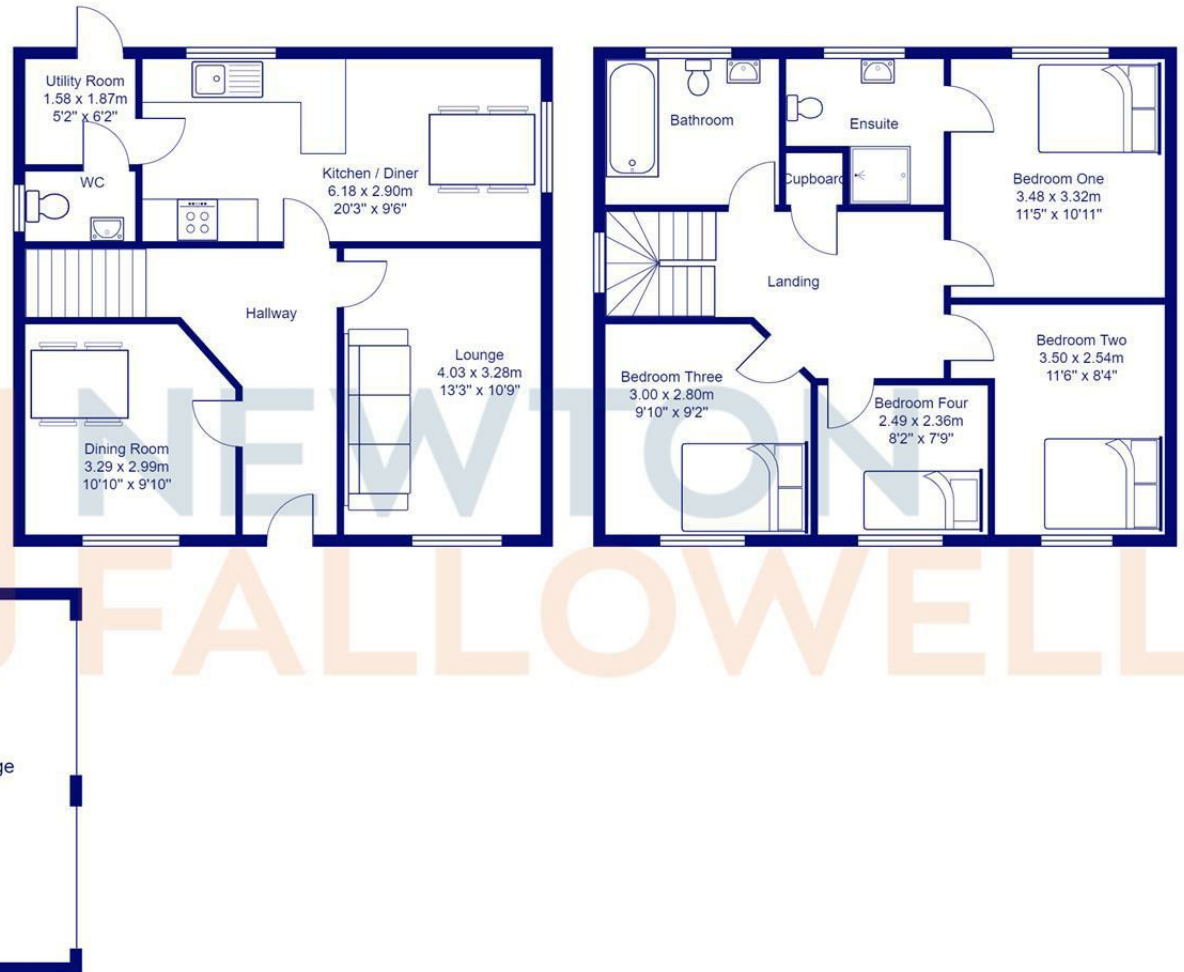

t: 01623424616  
e: mansfield@newtonfallowell.co.uk

